

DANSK

VIVO LINK™
PROFESSIONAL AV SOLUTIONS

INSTALLATIONSVEJLEDNING VLMC101-H



Udpakningsinstruktioner

Åben indpakningen forsigtigt og læg indholdet på et stykke pap eller en anden beskyttende overflade for at undgå beskadigelse. Kontroller at pakkens indhold stemmer overens med tilbehørs-oversigten på næste side. Kontroller også om de medfølgende komponenter er modtaget ubeskadiget. Brug ikke beskadigede eller defekte dele.

Vigtige sikkerhedsoplysninger

Montér og brug dette beslag med varsomhed. Læs venligst vejledningen inden påbegyndelse af montering og følg nøje alle instruktioner. Benyt passende sikkerhedsudstyr under montering. Kontakt venligst en kvalificeret håndværker for hjælp hvis du ikke forstår vejledningen eller er i tvivl om sikkerheden ved montering. Hvis du er i tvivl om din loftkonstruktion bedes du konsultere en kvalificeret installatør.

Brug ikke dette produkt til andre formål, eller i andre konfigurationer end de udtrykkeligt angivne i denne vejledning. Vi fraskriver os hermed ethvert ansvar eller skade som følge af forkert montering eller forkert brug af dette produkt.



WARNING

ADVARSEL!

Dette beslag skal være forsvarligt fastgjort til loftet. Hvis beslaget ikke er monteret korrekt, kan det resultere i at projektoren kan falde ned og eventuelt beskadige personer eller udstyr.

Nødvendigt værktøj

• 4 mm træbor

• 8 mm betonbor

• Stjerneskruestrækker

Bemærk: De skruer og beslag, der følger med denne indpakning, er ikke beregnet til montering i gipsloft, og du bedes derfor kontakte den lokale isenkræmmer for vejledning om hvilket tilbehør, som egner sig bedst til dette formål.

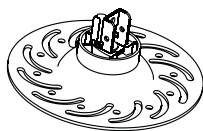

(1) Universal Bundplade - a

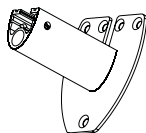

(1) Loftbeslag - b

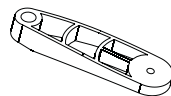

(4) Beslag arm - c



(4) M3x16 Bolt - d

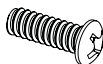

(4) M4x12 Bolt - e

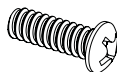

(4) M5x12 Bolt - f

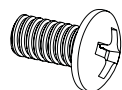

(4) M6x12 Bolt - g



(4) M3/M4 Spændeskive - h

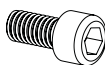

(6) M6x16 Umbraco Bolt - i

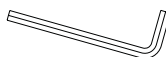

(1) Umbracnøgle - j



(3) Skruer - k



(3) Rawplugs - j

Vælg de rigtige monteringsdele

1. Vend projektoren og find fastgørelsespunkterne
2. Test vær enkelt skruestørrelse
3. De korrekte skruer skal passe til fastgørelsespunktet, og må ikke falde ud ved belastning/tryk



MONTERINGSSKRUENE MÅ IKKE OVERSPÆNDES MOD PROJEKTORENS KABINET. BRUG AF FORKERT SKRUEDYBDE KAN BESKADIGE DIN PROJEKTOR.

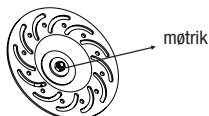

VIGTIGT

Du kan spænde denne møtrik, alt efter hvor meget du vil vippe/tilte projektoren. Men vær forsigtig med at overspænde møtrikken, da der i så fald kan opstå problemer med vippe-/tiltfunktionen.

DANSK

Step 1 Montering af beslag arme på projekteren

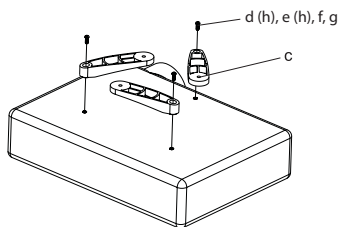

1. Find fastgørelsespunkterne på undersiden af projektoren.
2. Fastgør det korrekte antal arme (c) til projektoren ved hjælp af de medfølgende bolte (d (h), e (h), f, g).
3. Stram endnu ikke boltene helt.
4. Hvis du benytter M3/M4 boltene, skal du huske at bruge M3/M4 spændeskiverne (h).

Step 2 Montering af universal bundplade på beslag armene

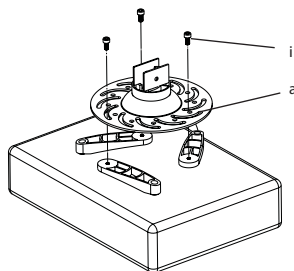

1. Tilpas universal bundpladen til beslag armene.
2. Placer armene for bedst mulig konfiguration. Det kan være nødvendigt at hejse eller sænke hver enkelt arm individuelt.
3. Fastgør armene til universal bundpladen ved at skrue M6x16 umbraco bolte (i) på beslag armene ved hjælp af den medfølgende umbracønøgle (j). Husk ikke at overspænde boltene.

Step 3 Montering af loftbeslag i loftet

Betonloft

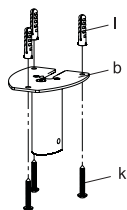
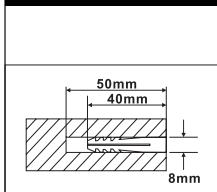

Benyt loftbeslaget (b) som en skabelon til at markere de steder, hvor de 3 huller i loftet skal placeres. Forbor disse huller med et 8 mm betonbor til mindst 50 mm i dybden. Indsæt rawplugs (I) i hvert hul. Sørg for, at rawplugsene sidder helt plant med betonoverfladen. Fastgør loftbeslaget til loftet ved hjælp af de 3 skruer (k).

Træloft

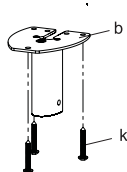
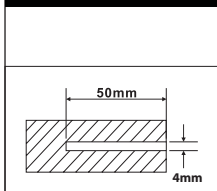

Benyt loftbeslaget (b) som en skabelon til at markere de steder, hvor de 3 huller i loftet skal placeres. Forbor disse huller med et 4 mm træbor til mindst 50 mm i dybden. Fastgør loftbeslaget til loftet ved hjælp af de 3 skruer (k).

Step 4

Montering af loftbeslag til universal bundpladen

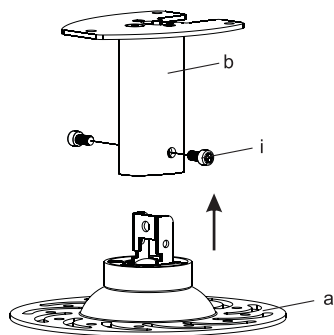

Fastgør loftbeslaget (b) til universal bundpladen (a) ved hjælp af de 2 M6x16 umbraco bolte (i) som vist på tegningen. Spænd op med den medfølgende umbracnøgle (j).

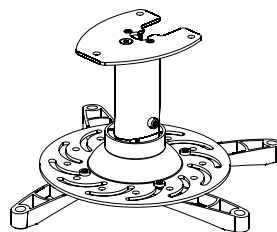

TAK FORDI DU HAR VALGT ET AF VORES PRODUKTER

**INSTALLATION INSTRUCTION
VLMC101-H**



Unpacking Instructions

Carefully open the carton, remove contents and lay out on cardboard or other protective surface to avoid damage. Check package contents against the Supplied Parts List in the next page to assure that all components were received undamaged. Do not use damaged or defective parts.

Important Safety Information

Install and operate this device with care. Please read this instruction before beginning the installation, and carefully follow all instructions contained herein. Use proper safety equipment during installation. Please call a qualified installation contractor for help if you don't understand these directions or have any doubts about the safety of the installation. If you are uncertain about the nature of your ceiling, consult a qualified installation contractor.

Do not use this product for any purpose or in any configuration not explicitly specified in this instruction. We hereby disclaims any and all liability or damage arising from incorrect assembly, incorrect mounting, or incorrect use of this product.



WARNING

CAUTION!

This projector mount must be securely attached to the ceiling. If the mount is not properly installed it may fall, resulting in possible injury and/or damage.

Tools Required

• 4mm Drill Bit

• 8mm Masonry Bit

• Philips Screwdriver

Note: The mounting components and hardware supplied in this package are not designed for installations to ceiling with steel studs or to cinder block. If the hardware you need for your installation is not included, please consult your local hardware store for proper mounting hardware for the application.

ENGLISH

SUPPLIED PARTS LIST

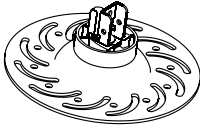

(1) Projector Plate – a

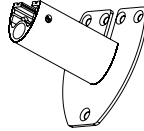

(1) Ceiling Plate with tube assembled – b

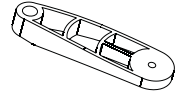

(4) Mounting Legs – c



(4) M3x16 Bolt - d



(4) M4x12 Bolt - e



(4) M5x12 Bolt - f

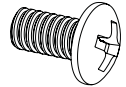

(4) M6x12 Bolt - g



(4) M3/M4 Washer - h

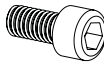

(6) M6x16 Hexangular Head Bolt - i

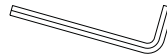

(1) Allen Wrench - j



(3) Philips Screw - k

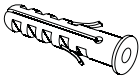

(3) Rawlplugs - j

Selecting the Proper Mounting Hardware

1. Invert the projector and locate the mounting points
2. Test each size of the screws provided
3. The correct screws should thread easily into the mounting point and not pull out when pressure is applied



DO NOT OVER-TIGHTEN YOUR MOUNTING SCREWS TO THE PROJECTOR CHASIS.
USING THE INCORRECT SCREW DEPTH MAY CAUSE DAMAGE TO YOUR PROJECTOR.

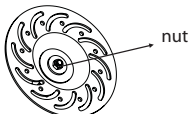

nut

ATTENTION

You can tighten this nut if you want to make the big tilting for your projector. But please don't over-tighten, otherwise you may have problem to do the tilting.

ENGLISH

Step 1 Install the Mounting Legs on the Projector

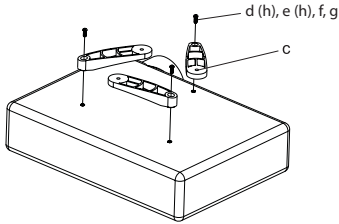

1. Locate the mounting points on the bottom of the projector.
2. Attach the appropriate number of Mounting Legs (c) to the projector using the appropriate mounting Bolts (d (h), e (h), f, g).
3. Do not tighten these bolts completely at this time.
4. The M3/M4 Washers (h) have to be used if you use the M3/M4 bolts.

Step 2 Install the Projector Plate to the Mounting Legs

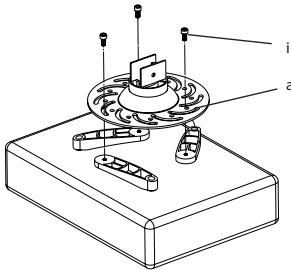

1. Align the Projector Plate (a) to the mounting legs.
2. Position the legs accordingly for best configuration. You may raise or lower each leg independently.
3. Secure the legs to the projector plate by screwing M6x16 Hexangular Head Bolt (i) (do not over-tighten) on the mounting legs, using the Allen Wrench (j) provided.
4. Tighten all bolts at this time.

Step 3 Install the Ceiling Plate to the Ceiling

Concrete Ceiling

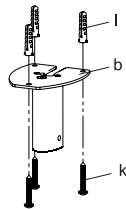
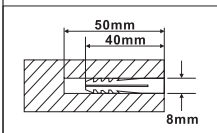

Use the Ceiling Plate (b) as a template to mark 3 hole locations on the ceiling. Pre-drill these holes with a 8mm masonry bit to at least 50mm in depth. Insert a Rawlplugs (l) into each of these holes. Make sure the rawlplugs is seated completely flush with the concrete surface. Attach the ceiling plate to the ceiling using 3 Philips Screws (k) and 3 Rawlplugs (l).

Wood Stud Ceiling

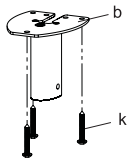
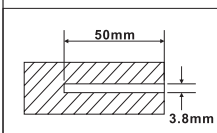

Use the Ceiling Plate (b) as a template to mark 3 hole locations on the ceiling. Pre-drill these holes with a 4mm drill bit to at least 50mm in depth. Attach the ceiling plate to the ceiling using the 3 Philips Screws (k).

Step 4

Connecting the Aluminum Tube to Projector Plate

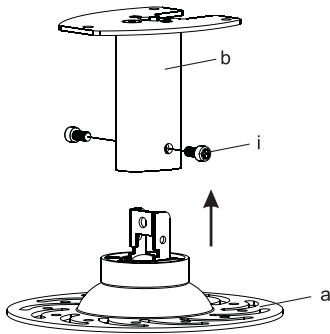

Connecting the Aluminum Tube (b) and Projector Plate (a) by 2 M6x16 Hexangular Head Bolts (i) as the picture, tighten by Allen Wrench (j) provided.

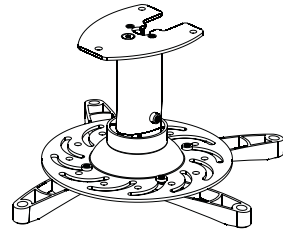

THANKS FOR CHOOSING ONE OF OUR PRODUCTS

VIVO  **LINK**™
PROFESSIONAL AV SOLUTIONS